



- Power Rating from to 1000A
- High Stability
- Low Inductivity
- Low Temperature Coefficient

## SPECIFICATIONS

ELECTRICAL	rated current	resistor value (at 50 mV nominal output)	P <sub>max</sub>
<b>FHR 2/4-120120</b>	1000 A	50 μΩ	50 W
<b>FHR 2/4-128120</b>	750 A	67 μΩ	38 W
<b>FHR 2/4-7580</b>	600 A	83 μΩ	30 W
<b>FHR 2/4-8080</b>	500 A	100 μΩ	25 W
<b>FHR 2/4-7050</b>	300 A	167 μΩ	15 W
<b>FHR 2/4-7750</b>	250 A	200 μΩ	13 W
<b>FHR 2/4-10050</b>	150 A	333 μΩ	8 W
<b>FHR 2/4-6520</b>	100 A	500 μΩ	5 W
<b>FHR 2/4-10020</b>	50 A	1000 μΩ	3 W

(other rated currents and nominal outputs upon request possible)

<b>Tolerances</b>	:	1%, 2%, 5% (other Tolerances upon request)
<b>Temperature Coefficient</b>	:	±15 ppm/K (20°C ... 60°C, only 4-pin type)
<b>Thermal EMF</b>	:	< 1 μV/K

## ENVIRONMENTAL

**Operating Temperature Range** : -40°C ... 130°C

## MECHANICAL

<b>Resistor Material</b>	:	Metalplate CuNiMn (DIN 17471)
<b>Connector Material</b>	:	Cu, upon request nickelized 2-pin, 4-pin

TEMPERATURE COEFFICIENT

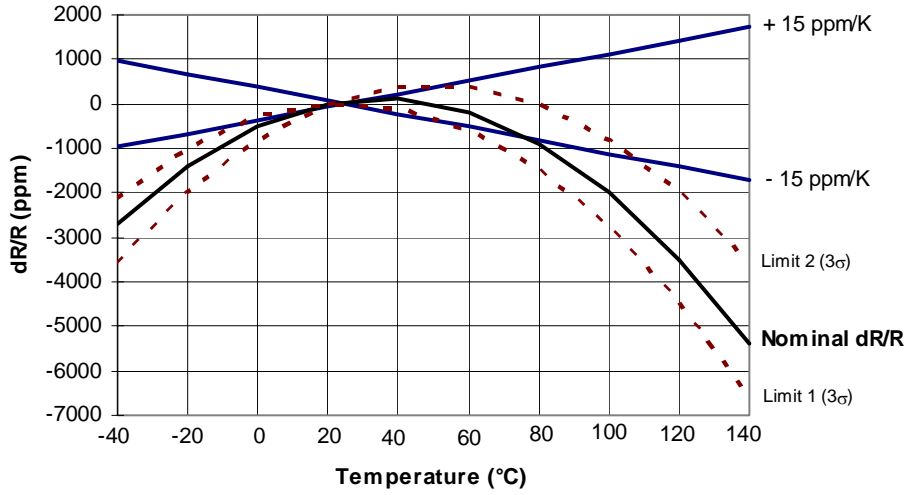

DERATING CURVE

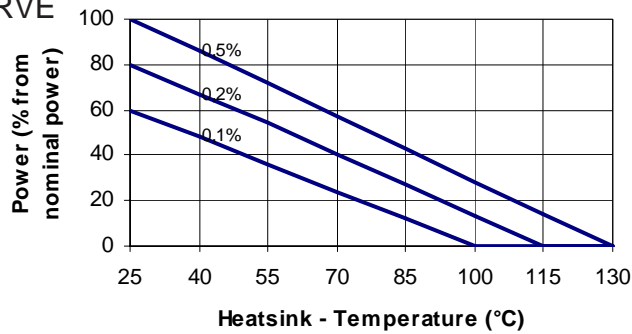

CONSTRUCTION

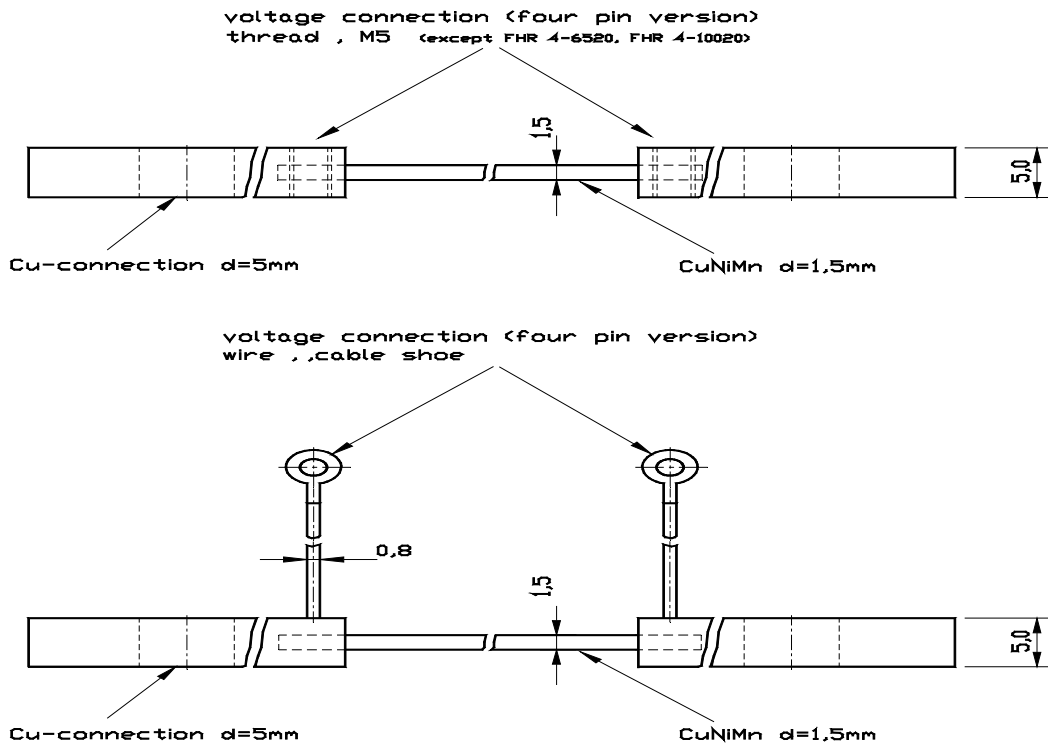

**DIMENSIONS**

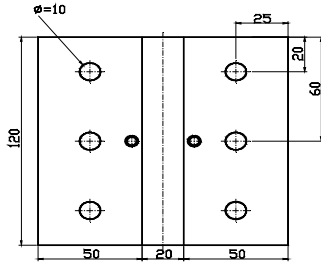

**FHR2/4 - 120120**

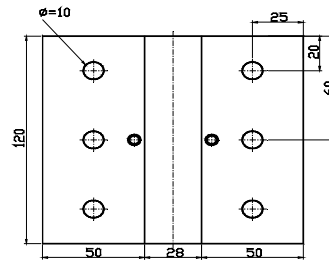

**FHR2/4 - 128120**

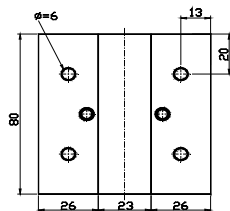

**FHR2/4 - 7580**

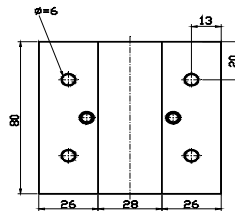

**FHR2/4 - 8080**

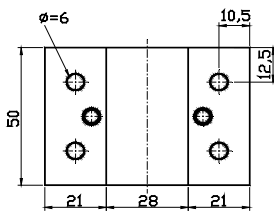

**FHR2/4 - 7050**

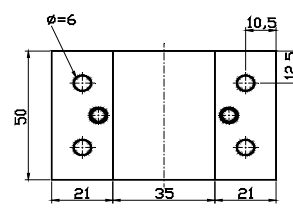

**FHR2/4 - 7750**

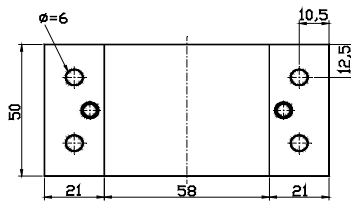

**FHR2/4 - 10050**

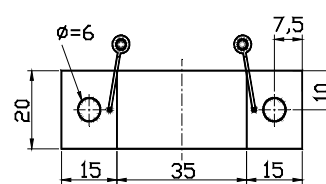

**FHR2/4 - 6520**

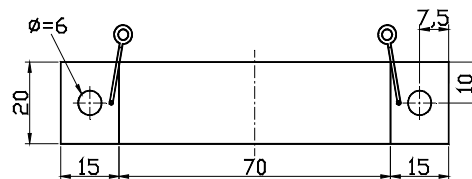

**FHR2/4 - 10020**

**HOW TO ORDER**

FHR 2-120120 0R00005 5%

FHR 4-8080 0R0001 2%

FHR 4-6520 0R0005 2%